



WALL MOUNT BASKETBALL BACKSTOP 3 FT EXTENSION

531-603

ITEM NO.	PART NUMBER	DESCRIPTION	QTY.
1	533-228	Mounting Board	1
2	533-230	Mounting Board	2
3	543-008	Aluminum Backboard	1
4	533-217	Official Goal	1
5	545-902	Nylon Net	1
6	543-202	Brace	1
7	603-207	Brace	1
8	533-251	Brace	1
9	533-252	Brace	1
10	533-233	Boom	1
11	196-610	3/8" x 2-1/2" Elevator Bolts	6
12	116-606	3/8" x 1-1/2" Hex Bolts	12
13	116-604	3/8" x 1" Hex Bolts	2
14	316-601	3/8" Flat Washers	12
15	216-601	3/8" Hex Nuts	12
16	545-506	3-1/2" x 3/4" Brace Clamp	8

IMPORTANT

PLEASE READ THESE INSTRUCTIONS BEFORE COMMENCING ASSEMBLY. All equipment must be installed in accordance with these instructions. Check your shipment against Bill of Lading and parts list. Any missing or broken parts must be reported to your distributor within 10 days of receipt of your order. When properly installed and maintained, equipment will give many years of Safe, Trouble Free use. Periodically check for loose or broken parts. Loose bolts must be tightened and broken parts must be replaced as they can possibly create dangerous situations leading to unnecessary accidents.

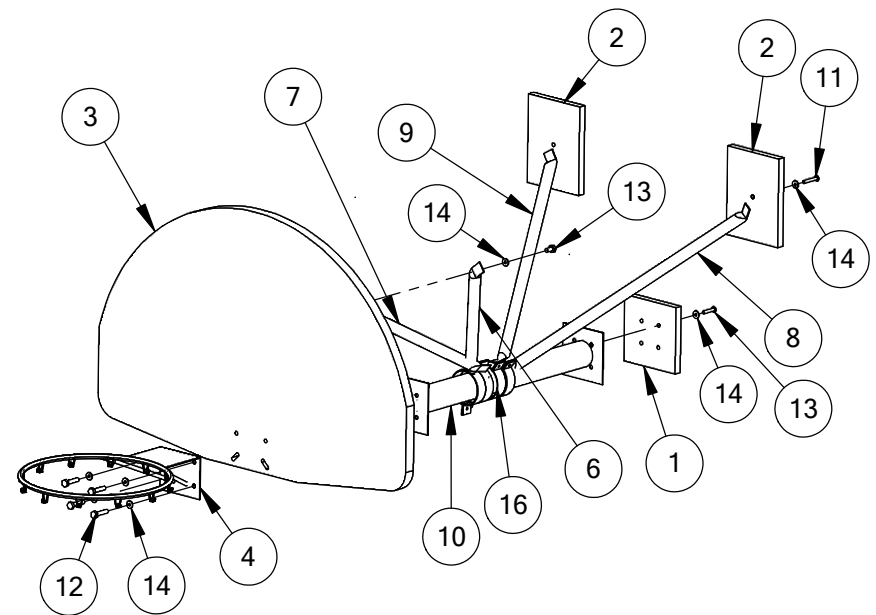



WALL MOUNT BASKETBALL BACKSTOP 3 FT EXTENSION

531-603

TOOLS REQUIRED FOR INSTALLATION:

- | | |
|-------------------|-----------------------|
| 1 Tape Measure | 1 Level |
| 1 Crescent Wrench | 1 9/16" Socket Wrench |

ASSEMBLY AND INSTRUCTIONS:

NOTE: All Threaded ends of bolts protruding beyond nuts must be cut off and/or peened to eliminate sharp edges. No more than two threads should extend beyond face of nut. All washers, "T" nuts, and other fastener hardware used on round pipe or tubing must be hammered down to conform to the curved underlying surface to eliminate catch points.

STEP #1 Attach 533-251 Brace and 533-252 Brace to 533-530 Mounting Board using:

- 2 - 3/8" x 2-1/2" Elevator Bolts
- 2 - 3/8" Flat Washers
- 2 - 3/8" Hex Nuts

STEP #2: Attach 533-233 Boom to 533-228 Mounting Board using:

- 4 - 3/8" x 2-1/2" Elevator Bolts
- 4 - 3/8" Flat Washers
- 4 - 3/8" Hex Nuts

STEP #3: Attach mounting boards to wall.

NOTE: Because of varied mounting surfaces (brick, siding, etc.) Fasteners to secure mounting boards to wall are NOT provided.

STEP #4: Attach 533-251, 533-252, 543-202 and 603-207 Braces using:

- 8 - 3-1/2" Pipe Clamps
- 8 - 3/8" x 1-1/2" Hex Bolts
- 8 - 3/8" Flat Washers
- 8 - 3/8" Hex Nuts

STEP #5: Attach 533-217 Goal and Net to 543-008 Aluminum Backboard using:

- 4 - 3/8" x 1-1/2" Hex Bolts
- 4 - 3/8" Flat Washers
- 4 - 3/8" Hex Nuts

STEP #6: Attach 603-207 and 543-202 Braces to back of 543-008 Aluminum Backboard using:

- 2 - 3/8" x 1" Hex Bolts

NOTE: The official height of a goal and net is 10 feet from floor to top of rim.