



ROPE AZTEC ADVENTURE 2 ASSEMBLY INSTRUCTION

1. Take out the metal and rope parts from its packages.
2. Assemble the metal parts as mentioned in Picture 1, 2, 3, 4, 5, 6 and 7.
3. Secure the metals standing vertical on embedded ground.
4. Embedded the metals to the concrete in assembly form.
5. Ropes are assembled on the structure after the end of concrete assembly. (Picture 8,9)
6. In the course of rope assembly, the inox M10x140 and M10x50 bolts which are on the rope system, get through holes on metals successively.

7. Fixing of bolts are shown on pictures with details.(Picture 11,12 and 13)

8. After rope assembly,while the Aztec walls on ground, should done the fixation with below metals.

9. Below metals fixed walls,as shown in Picture 17, 18, 19 and 20,places the ledge on metals.Then install nuts with bolt caps..

10. After finishing the assembly of opposite standing walls ,fix the below metals of walls to the concrete.

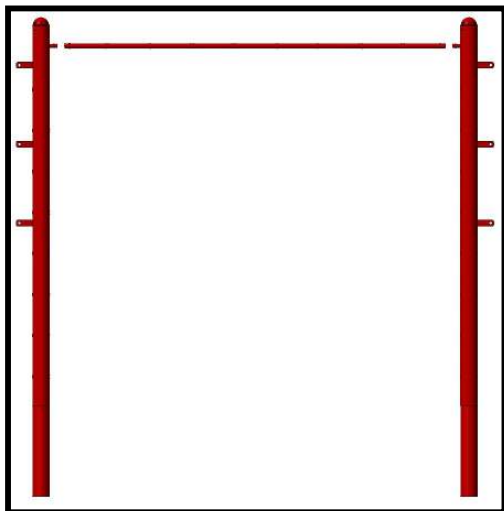

Picture 1

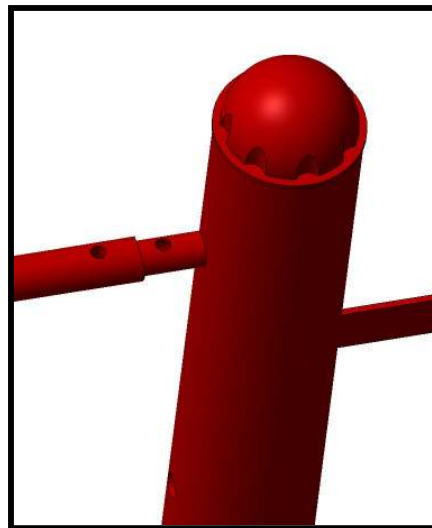

Picture 2

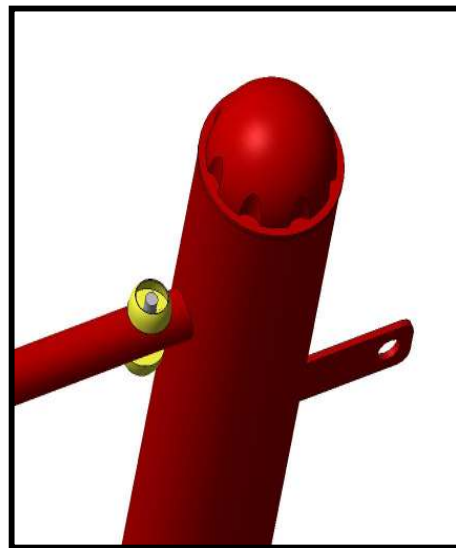
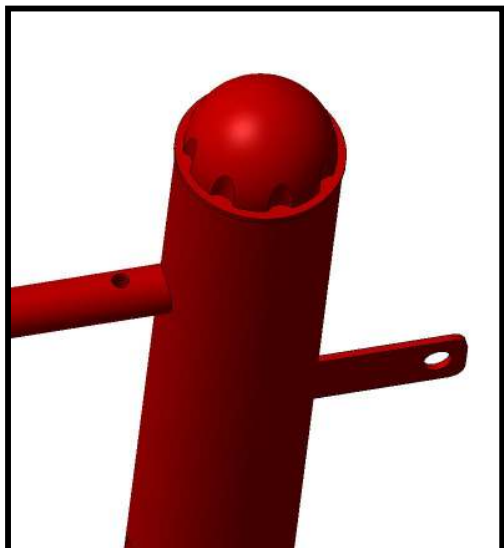

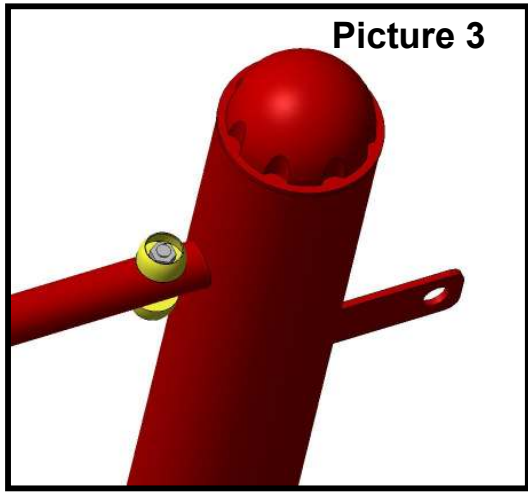

Picture 3

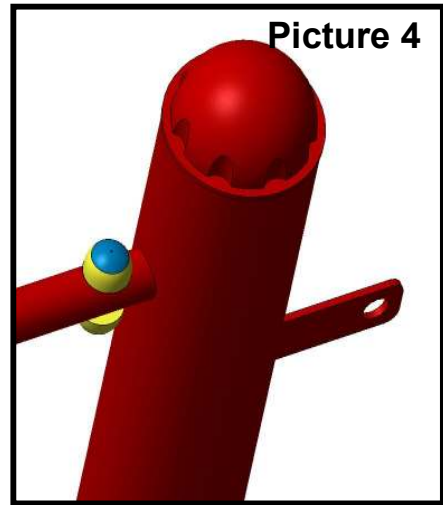

Picture 4

Picture 5

Picture 6

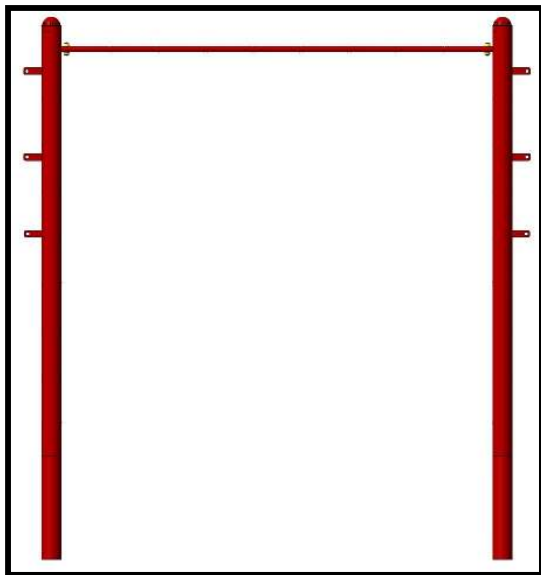

Picture 7

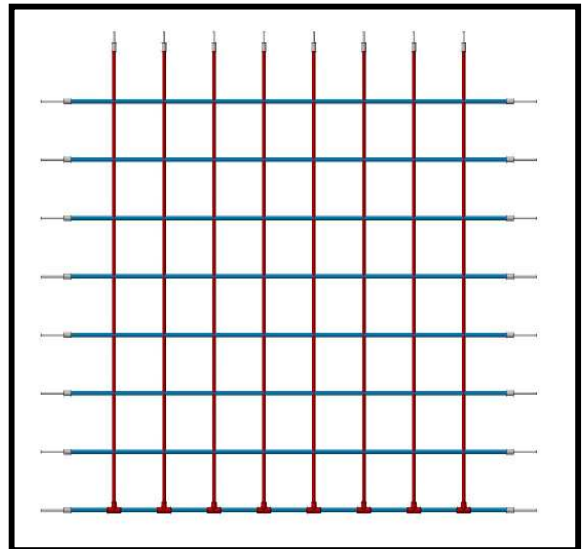

Picture 8

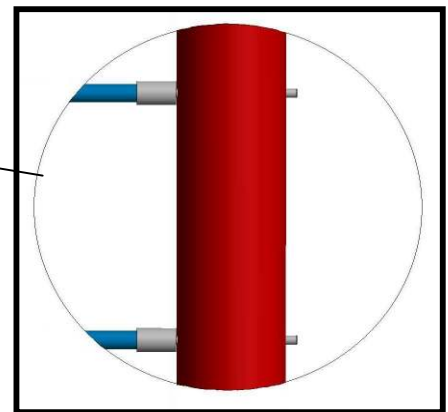
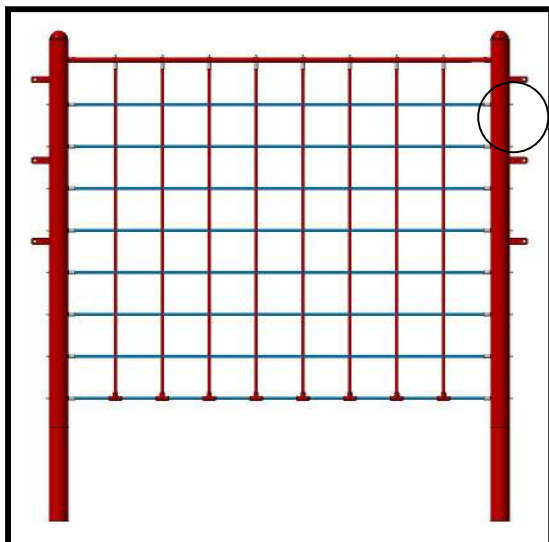

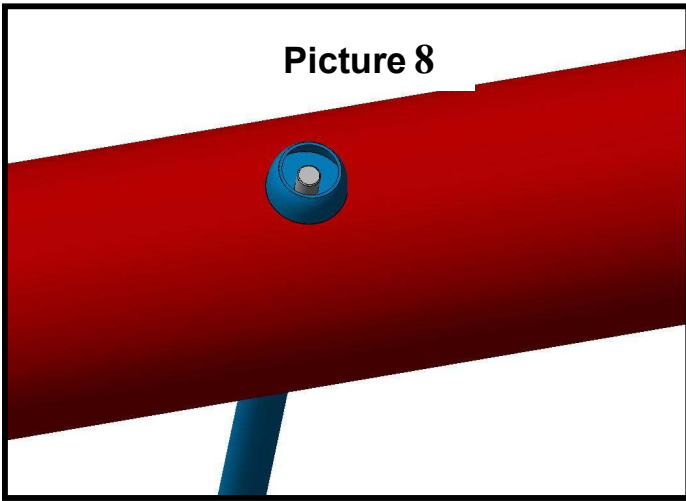

Picture 8

Picture 10

A.) After getting through the nuts at the end of ropes, bolt caps are getting through from nuts.,

Picture 11

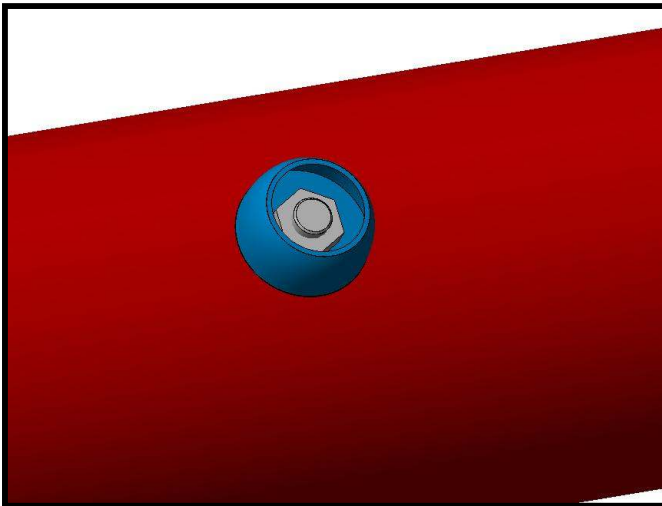

Picture 12

B.) After fixed the nut bolt cap, straighten the bolts on nut with appropriate spanner.

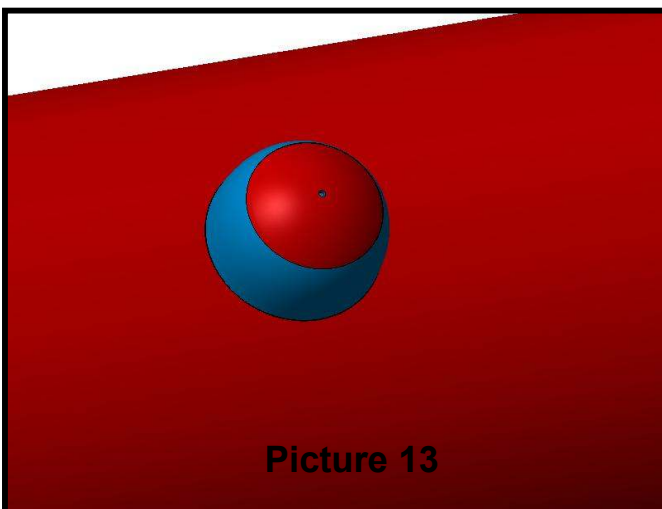

Picture 13

C.) After bolt straighten, fix the plug of bolt cap.

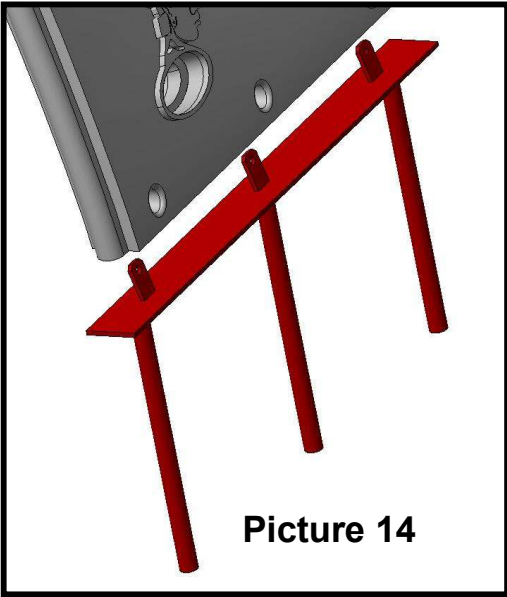

Picture 14

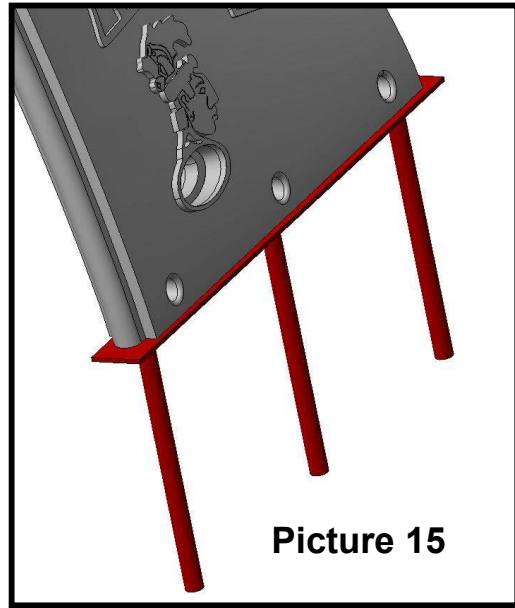

Picture 15



Picture 16

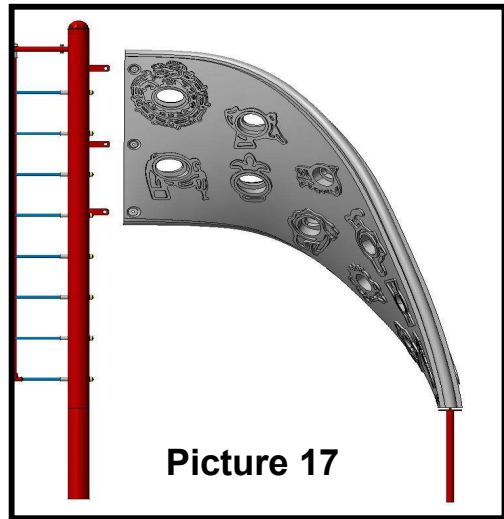

Picture 17

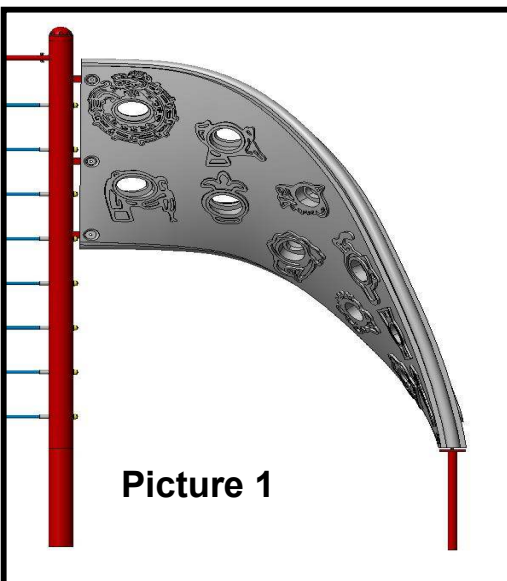

Picture 1

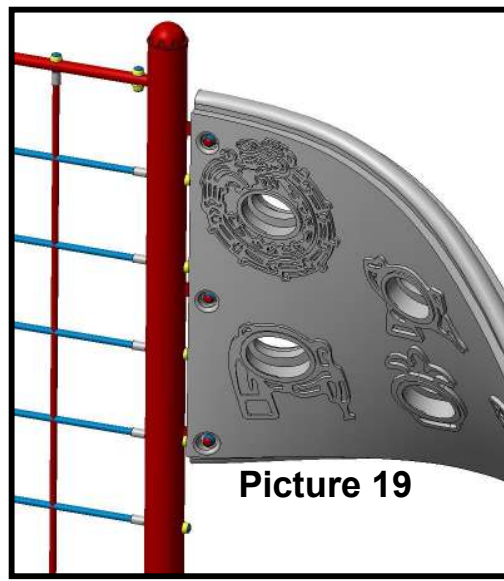

Picture 19

